

How to Setup SuperBox

S6MAX/ ULTRA



This manual is apply to the SuperBOX S6 MAX and SuperBOX S6 Ultra

Step 1 - Agree to the Disclaimer Notice - (Press [OK])

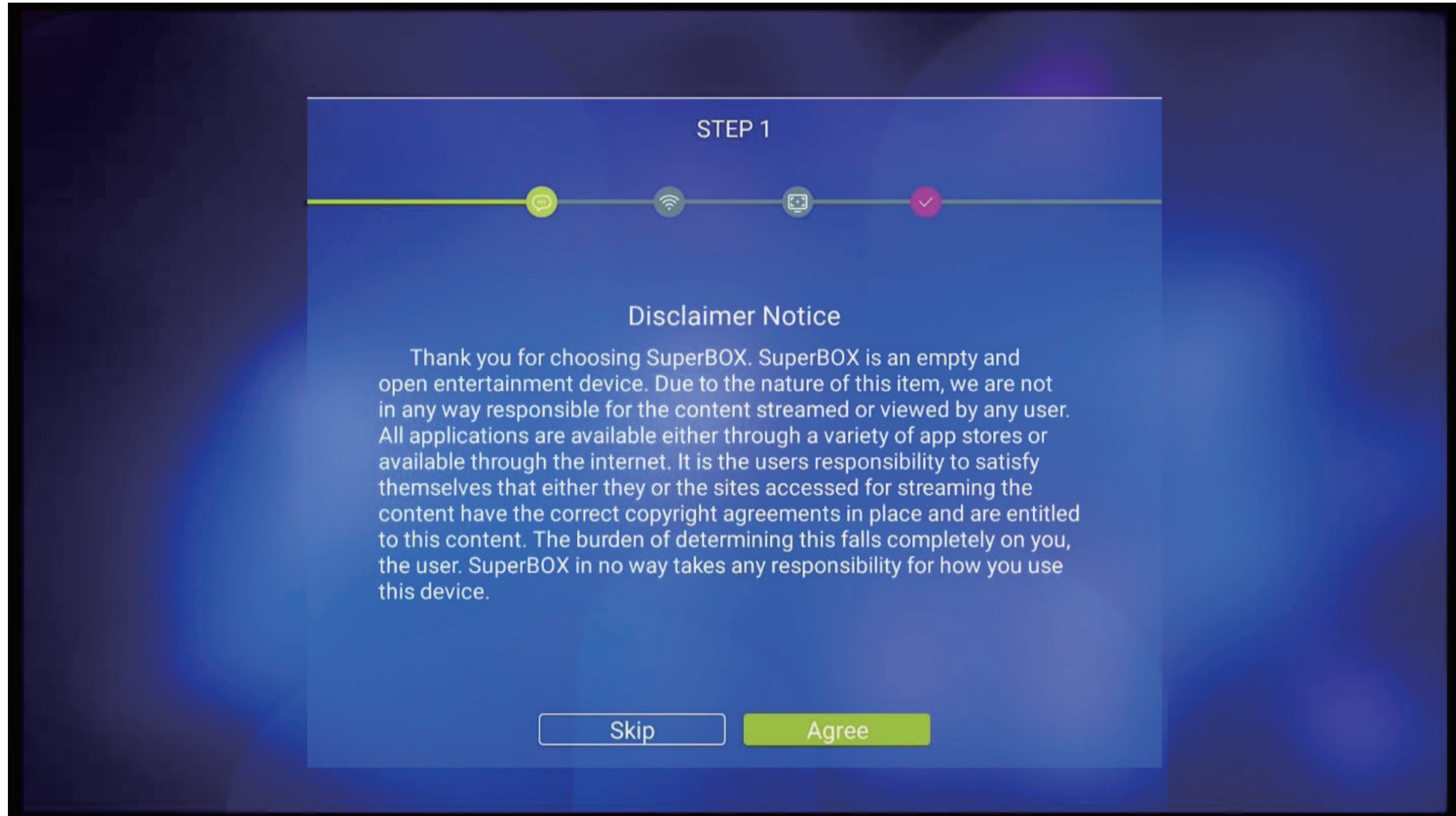

Step 2 - Select your internet connection (Either Ethernet or WiFi)

Step 2A - Ethernet Setup Plug into Router - (Press [OK])

Step 2B - WiFi Setup Select WiFi Network - (Press [OK])

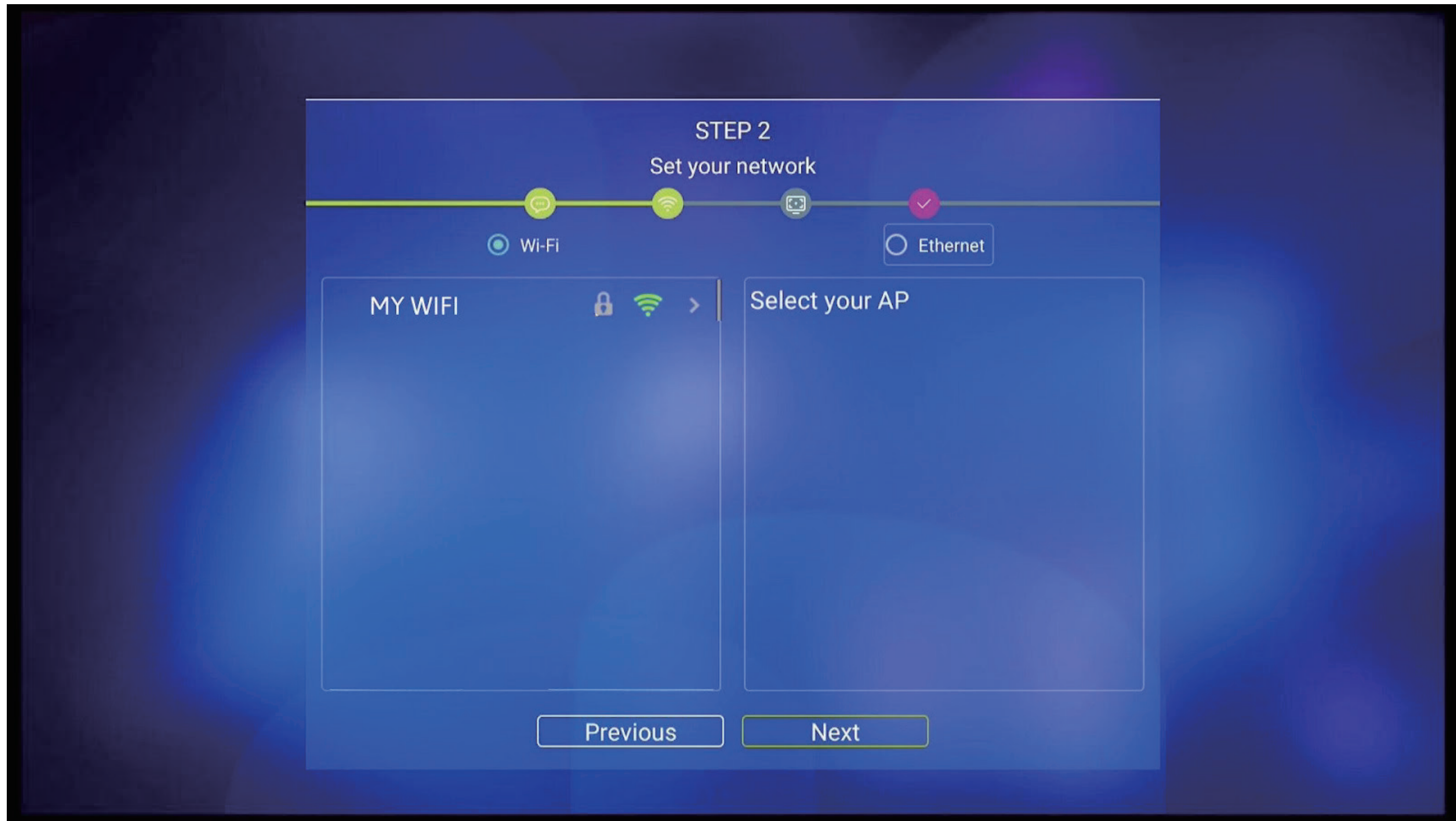

Step 2C - Enter Password (Press [OK] on [Check] to Save)

Step 2D - Arrow to Connect (Press [OK] to Connect)

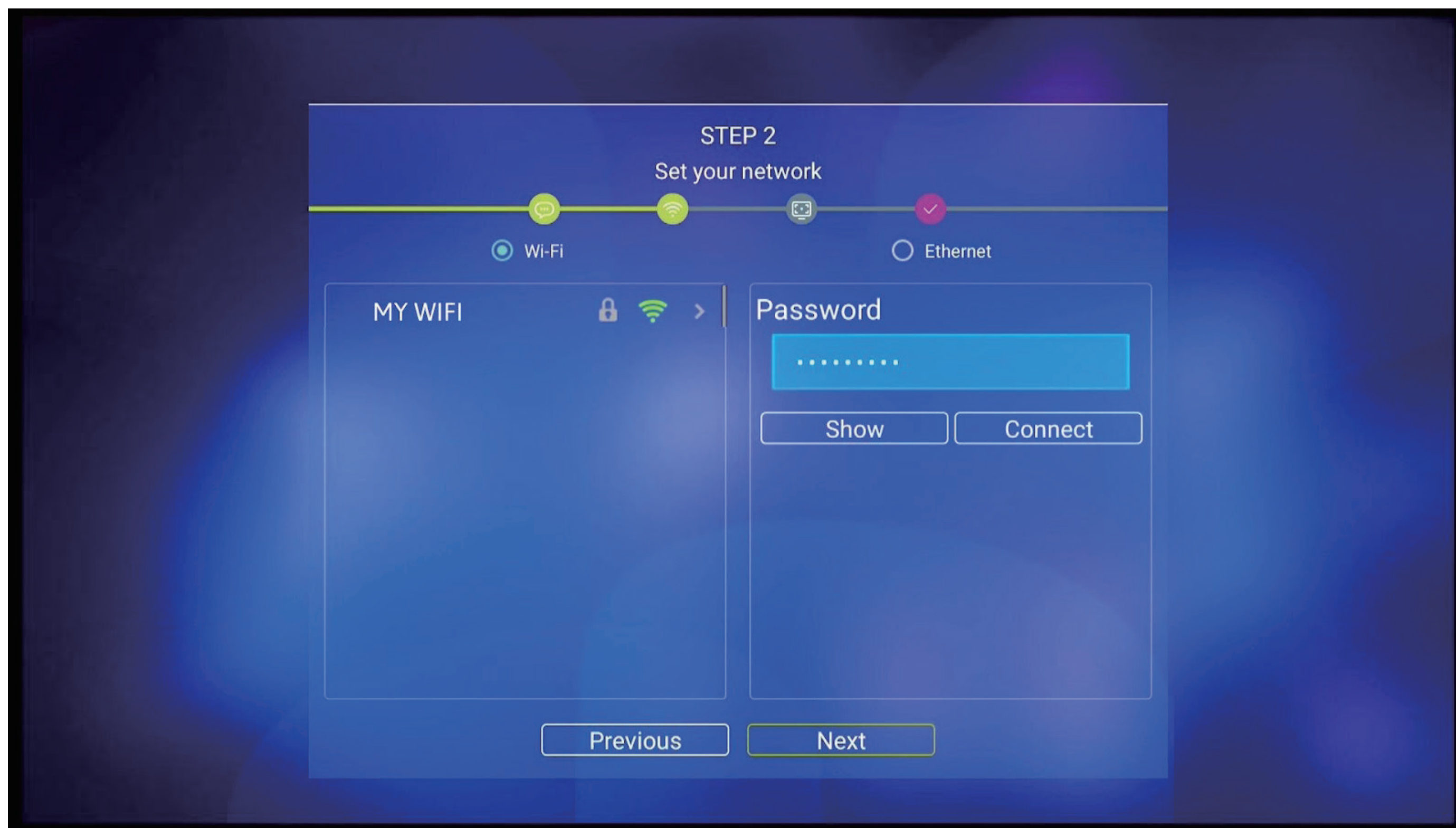

Step 2E - Arrow to [Next] (Press [OK] to Finish)

Step 3 - Adjust Screen to fit your TV

(Use UP/DOWN Arrows to Adjust - Press [OK] on Finish)

Step 4 - Pair Bluetooth Remote

Step 4A - Arrow down to Voice icon or Press the [VOICE] button on the Remote

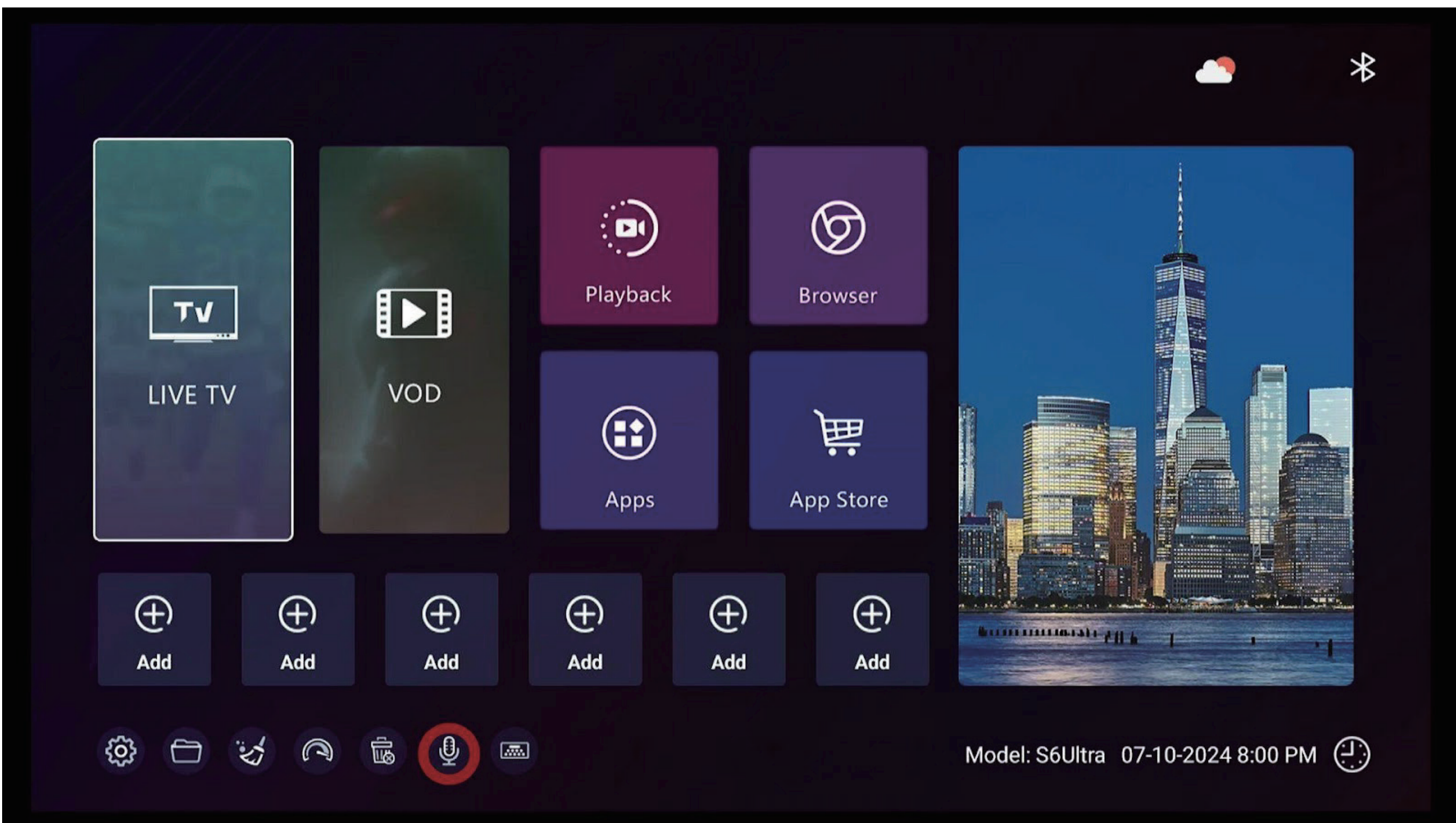

Step 4B - Hold [OK] and [Return] buttons together till indicator flashes

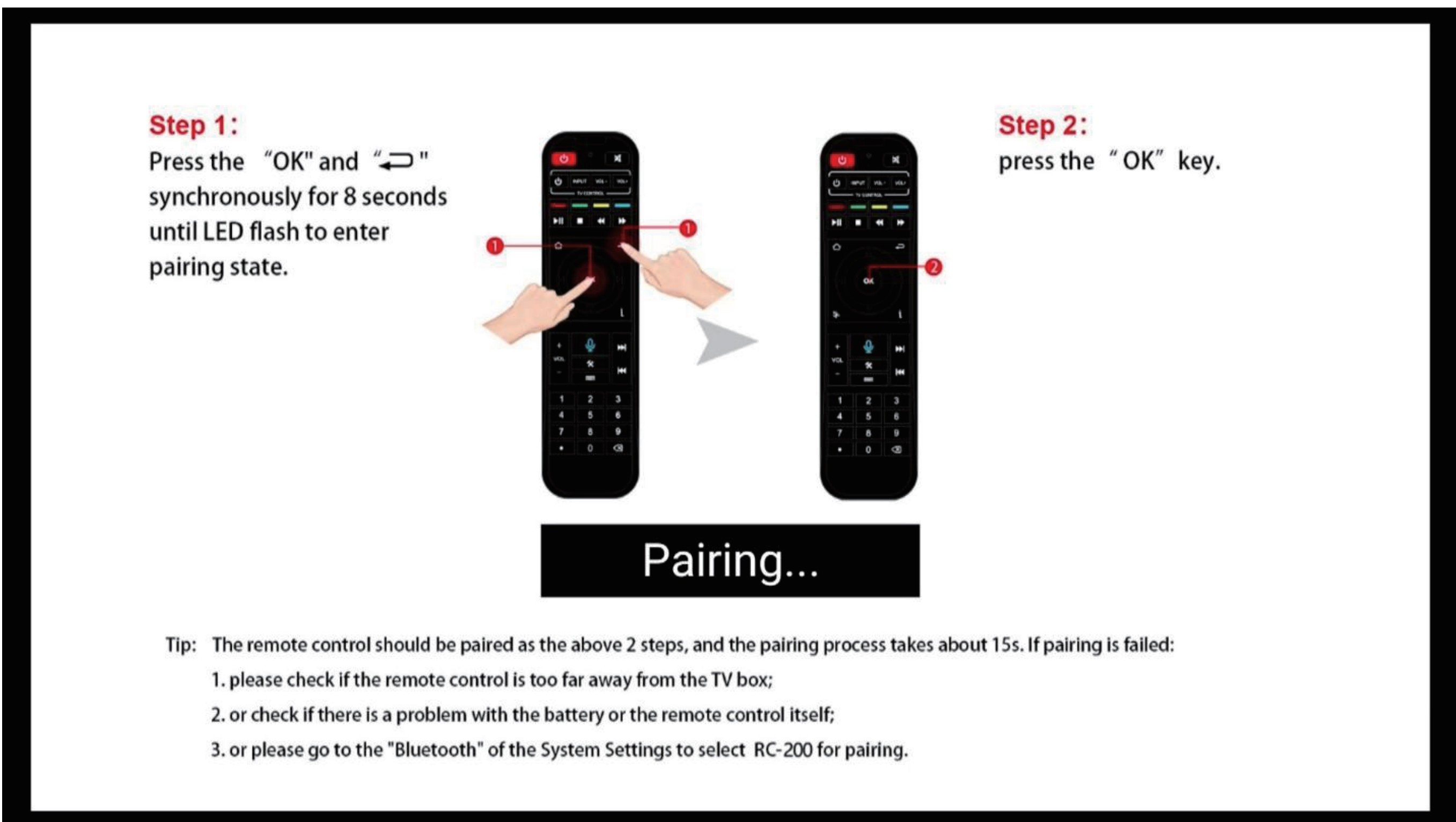

(Press [OK] and [Return] together - [OK])

Step 4C - Press [OK] to finish pairing

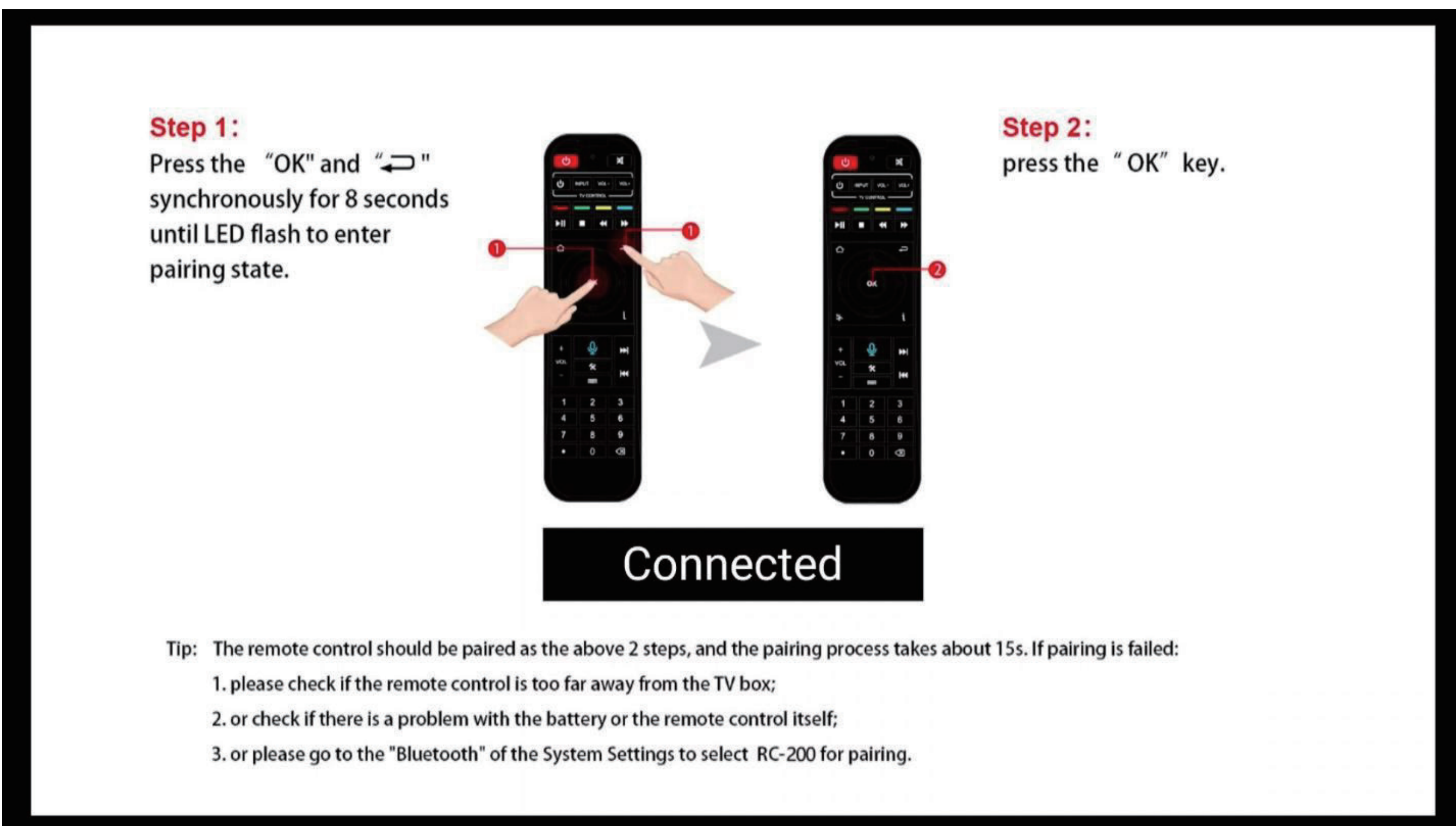

Now the remote turns into Bluetooth mode and you're able to use the Voice Command function

When speak to the remote in the first time, it will pup up the Google Assistant notice, select Sign in or Use Assistant without sign in